

**Versi Flash** 4000

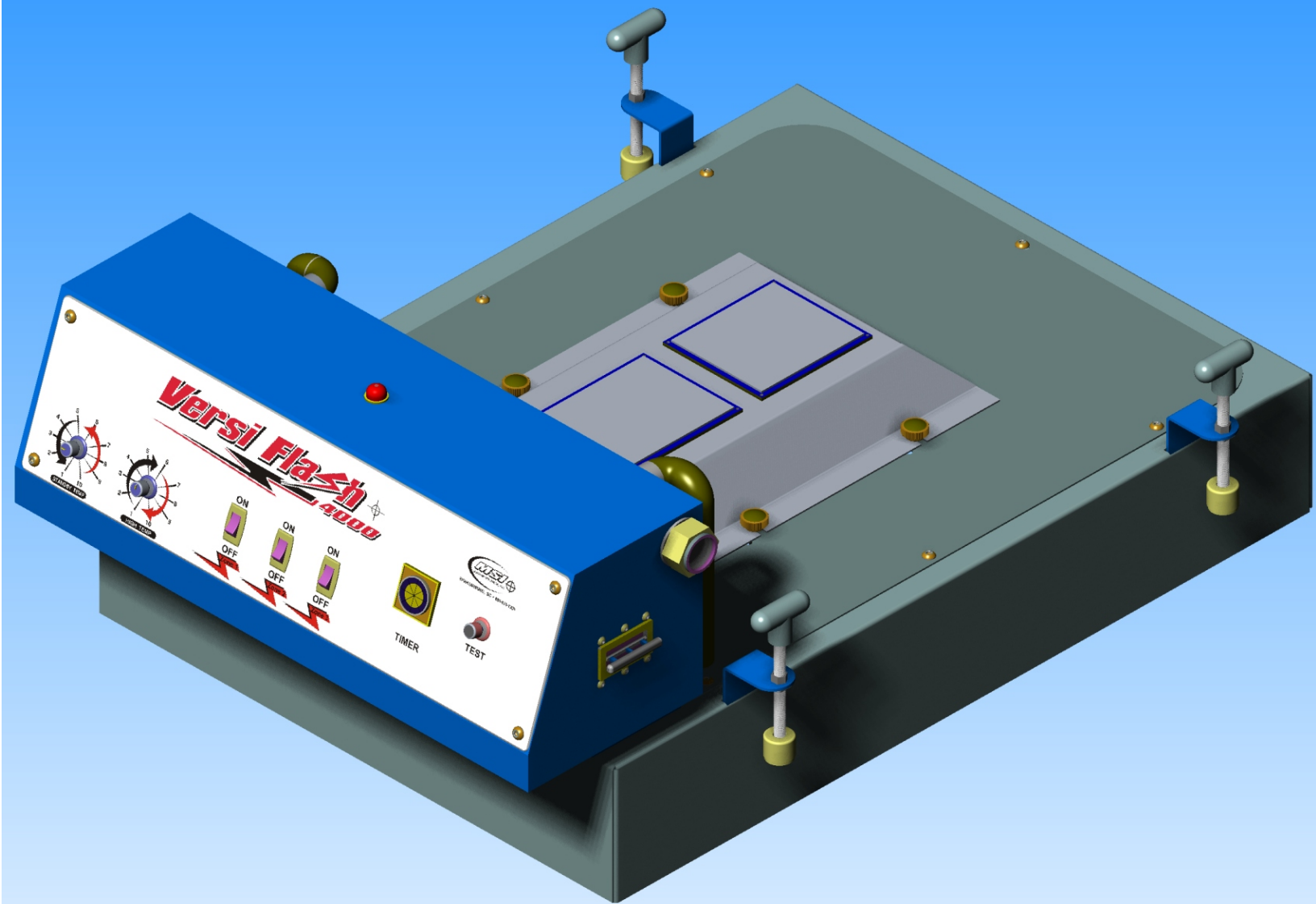

SPARTANBURG SC • 864-574-7200

# 22" x 30" Quartz Flash Cure Unit



# Instruction Manual

# Section 1: SAFETY

---

## **WARNING**

### **For Your Own Safety Read Instruction Manual Before Operating This Equipment**

The Versiflash 4000 is designed to quickly emit very high infra-red heat and can cause fire if not used properly. Always Test the unit prior to production to ensure that timing and power settings are correct. The Height of the Flash Above your Pallet is also very important. Make sure that all control features are checked and adjusted prior to every production run.

## **WARNING**

### **Check Pallet Clearance, Timer Dwell, and Power BEFORE EVERY PRODUCTION RUN**

## **WARNING**

**The Versi-Flash 4000 uses state of the art  
Quartz Emitter Technology.**

**The Bulbs are Delicate.**

**Handle them with extreme care.**



# Section 2: Circuit Requirements

Please Call us for electrical specifics if they are not filled in already for you.

\_\_\_\_\_ Volts

\_\_\_\_\_ Amps

\_\_\_\_\_ Phase

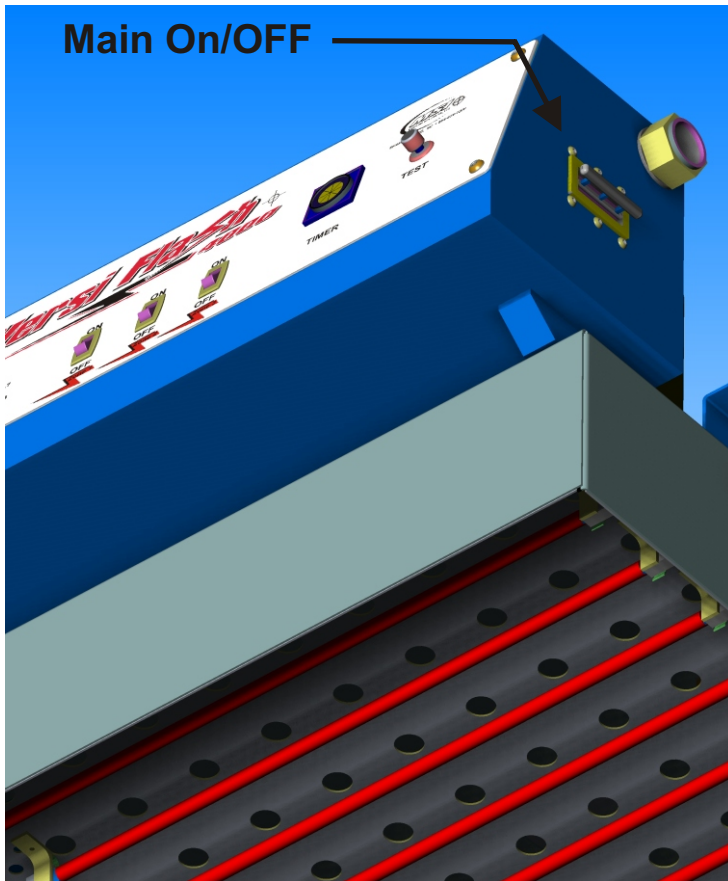

## ⚠ WARNING

This Unit should be connected to your house electrical service by a Professional Electrician Only



Failure to follow this specific direction will Void every and all warranties immediately. MSI will assume no responsibility for anything if you do not use a trained professional for wiring of the electrical service to this machine. **USE an ELECTRICIAN!**



SPARTANBURG, SC • 864-574-7200

# Section 3: Initial Setup

---

Great Care was taken when preparing your new Versi-Flash 4000 for shipment from our factory. Please ensure that the machine is inspected immediately upon arrival for any possible freight damage and report it immediately. Inspection should take place prior to signing the Bill of Lading.

## Section 4: Bulb Care

---

### ! CAUTION

The Bulbs of your machine are very carefully wrapped and separately packaged to ensure their safe arrival. These components are expensive , very delicate and should be handled with care and concern. Only Handle The Bulbs on the ends. Wipe with a soft cloth and alcohol for cleaning.

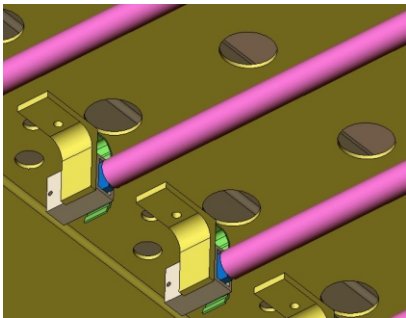

Prior to replacing damaged or expended bulbs, be absolutely certain that the Versi-Flash is completely unplugged from it's electrical service. Make sure to allow the bulbs and housing a minimum of 15 minutes to completely cool off before attempting to handle the unit and replace the bulbs.

### ! CAUTION



# Section 4: Operation & Controls

## ⚠ Read Carefully

### Standby Temperature

The Standby temperature adjustments controls should be normally set between 2-4. Adjustment controls the standby power of the VF4000

### Operating Temperature

The High Temperature controls the level of power being radiated. It should be adjusted and confirmed before each production run until the operator is comfortable with their best settings for their shop.

### Zone Controls 1, 2, & 3

The VF4000 has 3 user controlled zones to allow the operator to cure only the necessary areas. This will minimize your electric bill and has many additional benefits. Any combination or all zones are available for use at one time. **Use the TEST momentary pushbutton to observe which zones are selected.**

### Dwell Timer

This is the main timer unit and determines how long the unit will stay at it's peak power. This timer is only used if there is not a direct interface with your machine. All newer machines with Touchscreen Controls interface directly with your Vf4000 and will defeat the timer.

### Test Control

Momentary Push to Test. Use this control after turning your VF4000 'On' to ensure that power and zones are functioning properly.

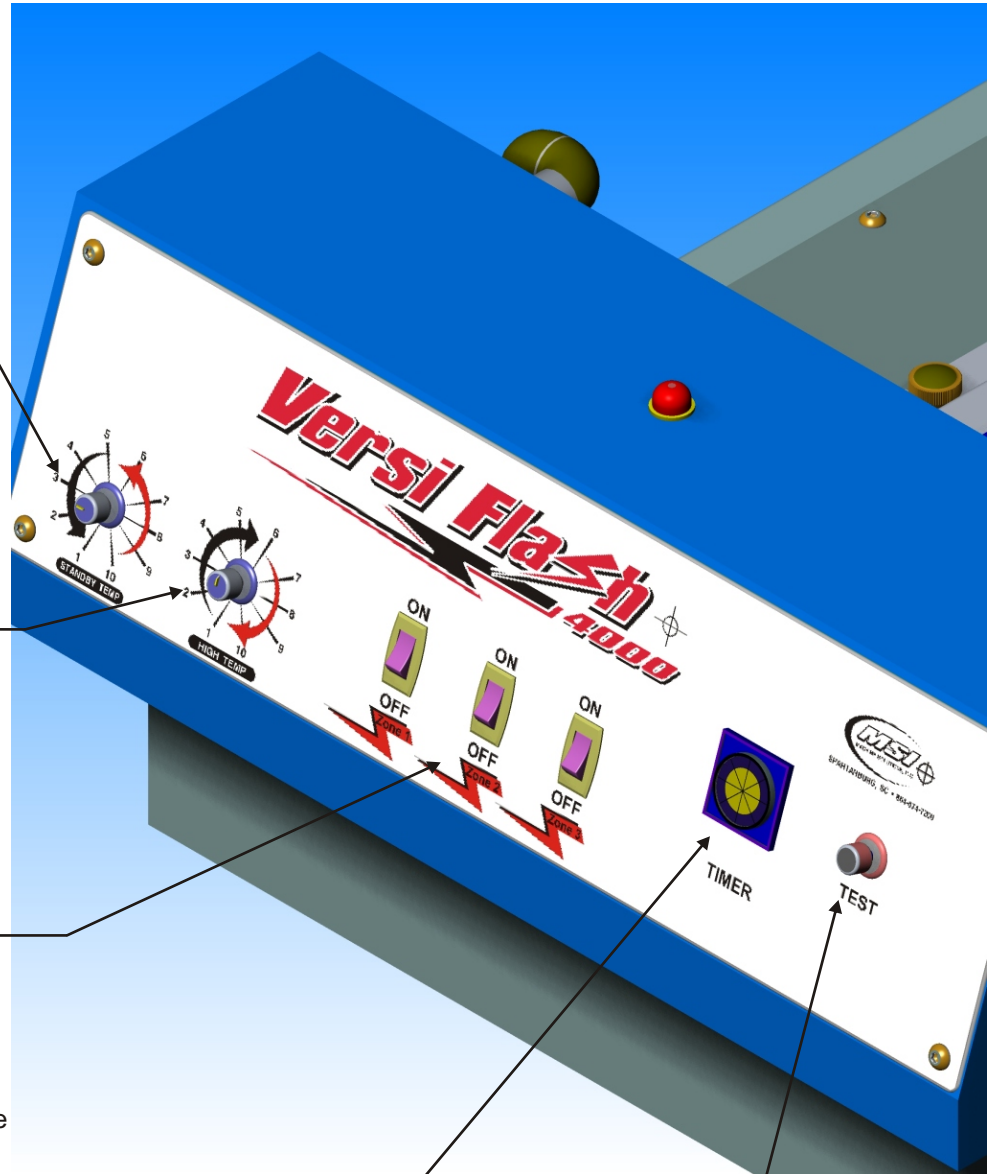



# Section 4: Operation & Controls

**! CAUTION:**

**Precision  
Adjustment Required**

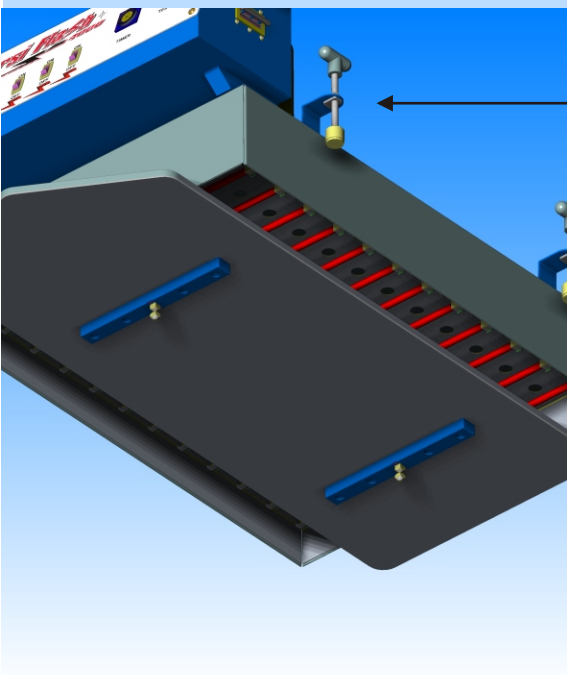
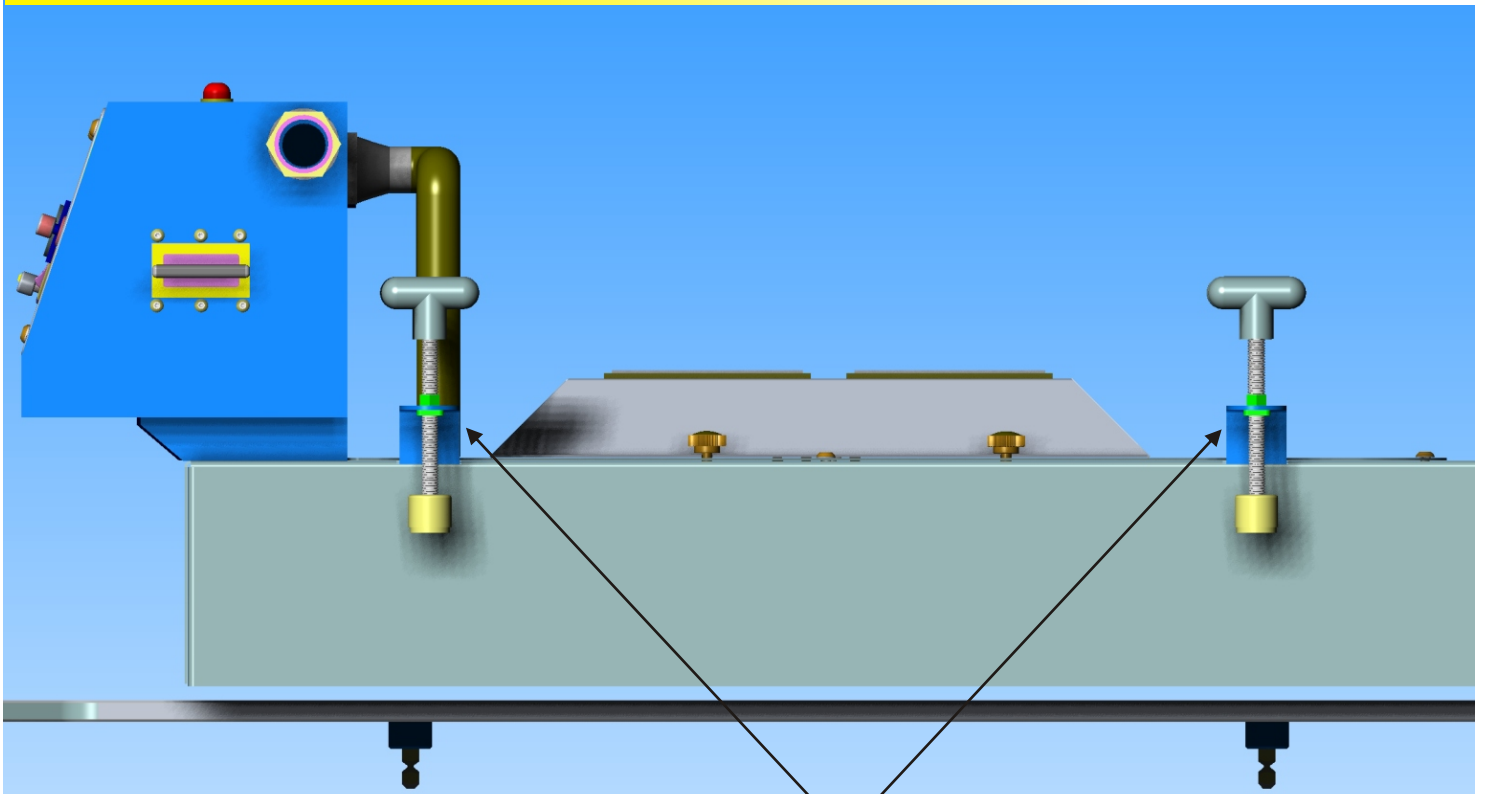

Precise Adjustment of your VF4000 Off-Contact is easily accomplished using these Knob-Stem assemblies. Be certain that your Flash Cure has appropriate clearance for the pallet and the garment. This distance is job and shop specific and should be tested prior to operation.

**! Read Carefully**  
**Avoid Bulb Damage**



# Section 5: Parts List

Part Number	Description	Replacement Date
VF1-06	SCR Board	
VF2-06	Solid State Relay	
VF3-06	Axial Fan	
VF4-06	Relay Timer	
VF5-06	110V Transformer	
VF6-06	10 Amp Fuse	
VF7-06	On/Off Switch 50 Amp Circuit Breaker	
VF8-06	T-Handles	
VF9-06	Axial Fan	
VF10-06	Fan Grill	
VF11-06	SS-Bulb-Holder	
VF12-06	Nylon Support Foot	
VF13-06	Sensor	
VF14-06	Standby Temp. Pot	
VF15-06	High Temp. Pot	
VF16-06	Zone Control Switch	
VF17-06	Dwell Timer	
VF18-06		
VF19-06	Medium Wave Lamp	

## CAUTION

Always disconnect your VF4000 from the power supply by unplugging the cord, prior to any troubleshooting or maintenance. Failure to do so will result in extreme displeasure, your possible death, and or your spontaneous combustion.





SPARTANBURG, SC • 864-574-7200

# Flash Settings

Date: \_\_\_\_\_  
Order Number: \_\_\_\_\_  
Customer Name: \_\_\_\_\_

	Type	Other	Standby Temperature	Operating Temperature	Zones Used	Dwell Time
Flash Cure #1	VF4000					
Flash Cure #2	VF4000					
Flash Cure #3	VF4000					
Flash Cure #4	VF4000					

### Notes:

\_\_\_\_\_  
\_\_\_\_\_



SPARTANBURG, SC • 864-574-7200

# Flash Settings

Date: \_\_\_\_\_  
Order Number: \_\_\_\_\_  
Customer Name: \_\_\_\_\_

	Type	Other	Standby Temperature	Operating Temperature	Zones Used	Dwell Time
Flash Cure #1	VF4000					
Flash Cure #2	VF4000					
Flash Cure #3	VF4000					
Flash Cure #4	VF4000					

### Notes:

\_\_\_\_\_  
\_\_\_\_\_

